

DISCTEQ

Dual HDD Clone Docking Station

Discteq - 352U - User Manual

Contents

Introduction	1
Packaging Contents	2
System Requirements	2
Docking Function	3
Clone Functions	5
Important Notes	6
Specifications	7
Technical Support	9
Warranty Information	9
Compliance	10

Introduction

Thank you for choosing the Discteq 2-in-1 hard drive cloning/docking device. In order to use the product correctly please read this Instruction manual, notes and safety indication of accessories.

The content of this Instruction book is the latest information relating to this device. If and when any relative content is changed it will be published on our website, <http://www.discteq.com>.

Discteq strongly advise that you to make a copy your data before commencing the cloning process incase of a power failure during the cloning process. Discteq cannot accept responsibility for the loss of data or the misuse of the device.

Please confirm the content of the packaging before commencing with the use of the device.

Packaging Contents

1 x Discteq hard drive dock

1 x Power Adapter with UK, EU power cords

1 x e-Sata Cable

1 x A-B USB Cable

1 x Instruction Manual

System Requirements

Available USB 2.0 Port

Available e-Sata Port

Available AC Power Outlet

Operating System (Microsoft Windows XP and Above, Apple Mac OS X or Linux)

Docking Function

To use the dock to access external hard disks you will be required to use either the USB/ESATA lead, which will need to be plug into the laptop/computer system as illustrated below, the operating system will 3/4 seconds to recognize the device at which point it will automatically configure for use as required, this apply to All Microsoft, Macintosh and Linux operating systems.

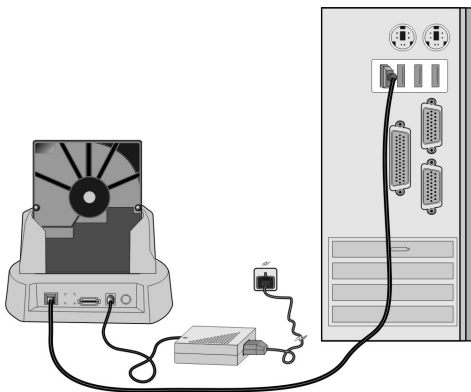

Do not connect the USB/ESATA cables at the same time, you must connect one or the other BUT NOT BOTH

It is possible to dock 2 hard disk in any configuration e.g.. 2.5/3.5 2.5/2.5 3.5/3.5 externally both drives will be allocated a drive letter by the operating system, it is also possible move data between all drives listed within your operating system

Once you have located the drives in the dock, power the device on, the LED's will light up and the operating system will begin the configuration process, once this is complete you will be able to view and access the hard disks.

Clone Functions

One Key Clone (From HDD1 to HDD2) without connecting computer.

- Insert the Master hard disk to be cloned into bay 1
- Insert the new Secondary hard disk into bay 2
- Plug the power unit into the device and power up with the power switch
- Press the COPY button then LED's will light up (100%)
- Press the COPY button again within 3 seconds of the first press the 100% will go out then the 25% will light flash, and the cloning process will begin.

If you fail to press the copy button within 3 seconds of the first press, you must start process again.

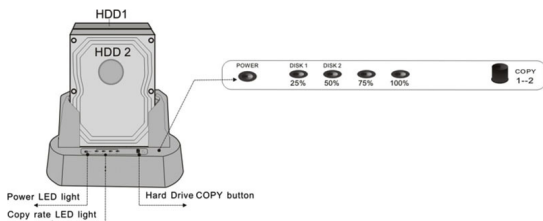

The LED lights will flash to indicate the cloning process (25% / 50% /75% /100%) once the cloning process has reached the 100% it will change from a flashing blue light to a static blue light which will indicate that the cloning process is complete.

Before removing the hard drives from the cloning device we strongly recommend that the device is powered off and the power supply removed from the device.

Important Notes

To successfully use 2-in-1 Cloning the capacity of target hard disk must be larger or the same the size as the original hard disk. (Please note data cannot be cloned to a smaller drive).

Once you have pressed the copy button for the first time and the 100% light is lit you must press again within 3 seconds to confirm the cloning process.

Do not connect the USB/ESATA cables to the PC when the cloning process is operational as this may cause corruption of the hard disks.

Do not connect the USB/ESATA cables at the same time whilst docking, it must be one or the other BUT NOT BOTH

Specifications

Item

2.5"/3.5"Dual bay Docking Station

Model

CA-07 - 352U

Dimension

180mm x 135mm x 96mm

Weight:

300g

External Interface

USB2.0

Max Transfer Rate

480Mb/s

Capacity

2TB (Max)

Power Supply

DC 12V/3.0A

Clone Function

One Key Clone (from HDD1 to HDD2) without PC

Compatible Type

Desktops, Notebook

LED Light

Power LED from red to green

Signal LED

Blue Flashing

Storage Temperature

-40~70C

Operating temperature

5~55C

Operating Relative Humidity

5~90%

Operating System

Windows 98 / ME / 2000 / XP / Vista / 7 / Mac OS.9.0 or above

Technical Support

Discteq has life of product technical support, should you require technical support please visit our website <http://www.discteq.com> where all know issues and resolution will be listed, should you not find a resolution to your problem then please feel free to contact technical support on,

support@discteq.com

Warranty Information

Discteq is covered by a one year RTB (Return To Base) warranty, Discteq warrants the materials and workmanship for the period of one calendar year from the date of purchase, during this period the product may be returned for repair or replacement of the equivalent products (Note: outward shipping costs are at the clients expense, Discteq will pay the return shipping costs) Discteq does not warrant its products from defects or damages arising from the misuse, abuse, alteration, or normal wear and tear.

Compliance

The Discteq hard disk cloning/docking device has passed complicity testing and meets the required standards for CE, RoHS and FC and is approved for sale in the United Kingdom, Europe and the United States of America, compliancy certificates are available up on request.

Limitation of Liability

In no event shall the liability of PC Doctors Limited t/a Discteq or their officers, directors, employees or agents for any damages whether direct or indirect, special, punitive, incidental, consequential or otherwise loss of profits, loss of business, or any pecuniary loss, arising out of or related to the use of this product exceed the actual price paid for the product.

Made In China Distributed In The UK
WWW.DISCTEQ.COM

Discteq is the trading name of PC Doctors limited based in Coventry West Midlands, we are the providers of Hard Disk Drive duplication and docking products to the UK market, The Discteq brand is solely owned by PC Doctors Limited, Our Hard Drive duplicator and docking products are developed specifically for Discteq and undergo rigorous testing to ascertain their practicality and suitability for the UK I.T Market place.

PC Doctors limited, originate from the I.T support sector and have been providing I.T support and I.T network design services since 1995 to an array of clients ranging from national Hotel Groups to Sporting Venues such as the award winning Ricoh Arena in Coventry and the Millennium Stadium Cardiff. PC Doctors is now trading as Verilan.

In serving our clients we have encountered many time consuming Hard Drive related problems, from the simple I need more Hard Drive space to the my Hard Drive has crashed, these issues have inspired the birth of Discteq, Discteq will bring innovative low cost time saving Hard Drive Duplication, Docking and Data transfer products to the UK market supporting USB 2.0-3.0, SATAI-II eSata, SAS and SSD, suitable for use by the enthusiast, right through to the fully qualified onsite-field I.Tsupport engineer.



RoHS
2002/95/EC

